

D50/55 WITH PVC SWING JOINT

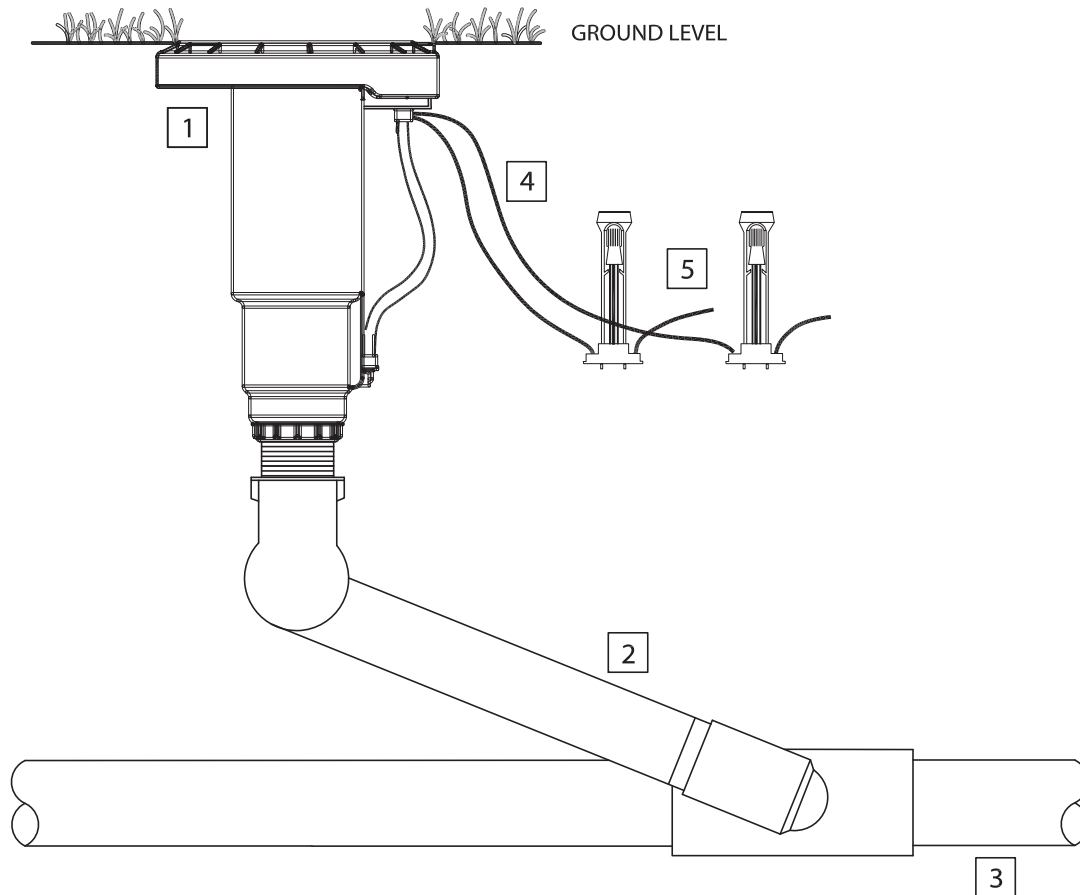

- 1 SIGNATURE D50/55 ROTOR
- 2 1 1/4" X 1" SWING JOINT
- 3 PVC LATERAL PIPE
- 4 WIRES TO CONTROL VALVE
- 5 "DBY" WIRE SPLICE

NOTES:

- > FOR CONNECTION TO PVC LATERAL PIPE USE SCH 40 FITTINGS
- > CONNECTION TO THE LATERAL SHALL BE SOLVENT WELD
- > ANGLE OF SWING JOINT ARM AND LATERAL SHALL BE BETWEEN 30 AND 45 DEGREES
- > LATERAL BURIED AT 18" COVER
- > 1" INLET AVAILABLE IN ACME, BSP OR NPT
- > BURY "DBY" WIRE SPLICE WITH SNAP LIDS UPSIDE DOWN TO PREVENT FILLING WITH DIRT AND WATER