

## AC016UGD

## Component Parts/Packing List

### C-Style Expansion Kit, Premium Surge

Includes Valve Module ACVLV216 [Front Module] with Wiring Harness, Valve Terminal Module ACTRM016 [Back Module] PLUS Mounting Kit ACRMBRKT

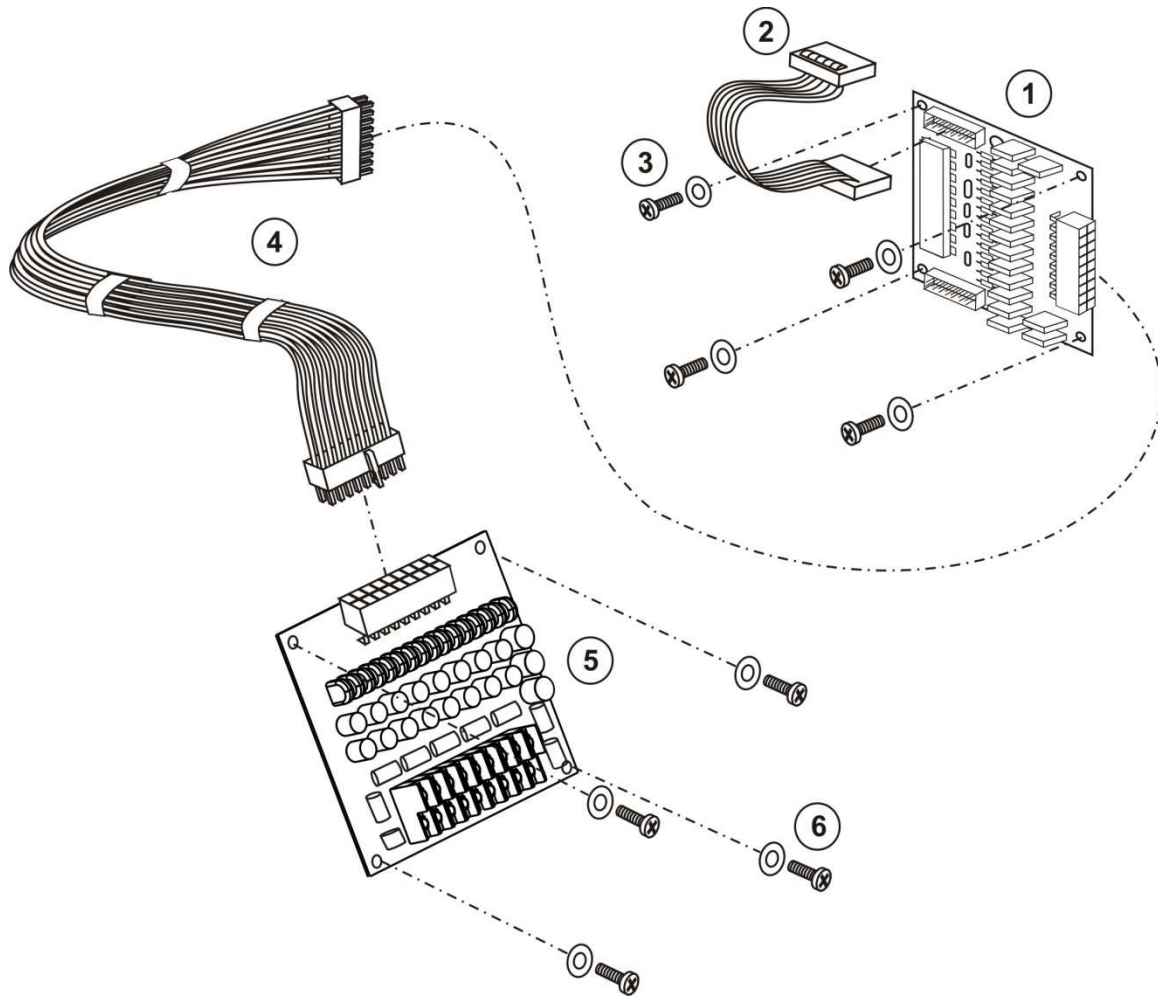

Ref.	Part No.	Description	Qty
	<b>AC016UGD</b>	<b>C-Style Expansion Kit, Premium Surge</b>	<b>1</b>
1	ACVLV216	Valve Module, C-Series, 16 Zone, Large Terminal, No Surge [Front Module]	1
2	ARCBL1.5	Cable, Valve Module Bus, 1.5 in (38.1 mm)	1
3		Screws and Washers, for Valve Module Mounting	4
4	ACTWH25	Wiring Harness, C-Series, 25 in (635 mm)	1
5	ACTRM016	Valve Terminal Module, C-Series, 16 Zone, Large Terminal, Premium Surge [Back Module]	1
6		Screws & Washers, for Valve Terminal Module Mounting	4

## AC016UGD

## Final Installation

### C-Style Expansion Kit, Premium Surge

Includes Valve Module ACVLV216 [Front Module] with Wiring Harness, Valve Terminal Module ACTRM016 [Back Module] PLUS Mounting Kit ACRMBRKT

#### Final Install of Expansion Kit

1. Install on front of Pedestal Chassis: Mount Valve Module (1), use four small bolts & washers (3). Plug in Cable Valve Module Bus (2) to top Connector; connect other end to upper Valve Modules. (See Front View)
2. Install on back of Pedestal Chassis: Mount the Valve Terminal Module onto Bracket standoffs (5), use four small bolts & washers (6). (See Back View)
3. Connect Harness (4) to top Connector of the Valve Terminal Module (5) and guide the other end through Chassis and connect to the front Valve Module (1). (See Front View)

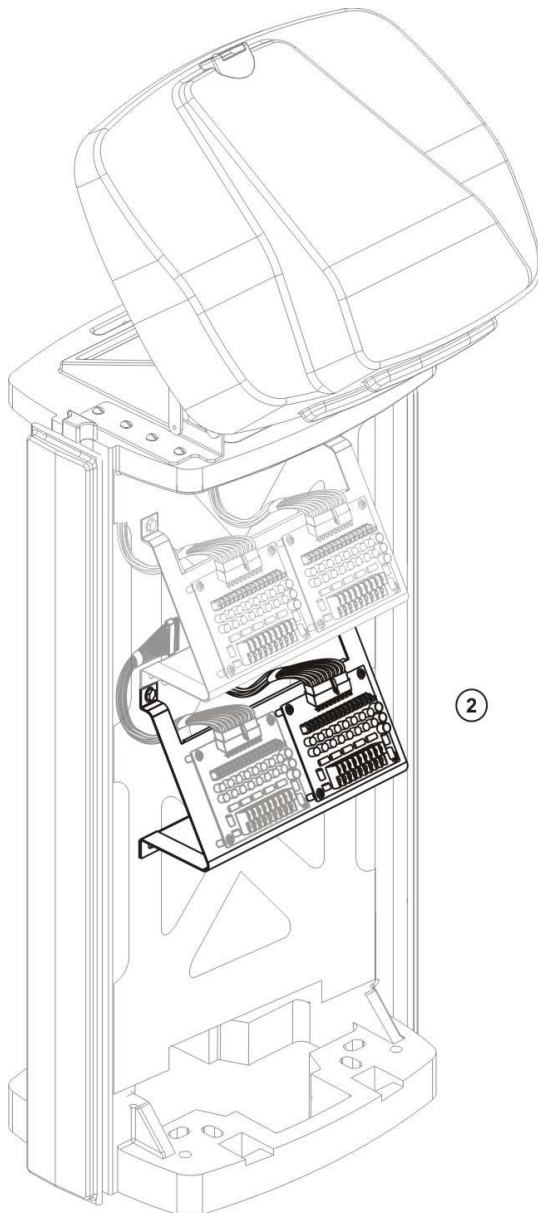

Back View

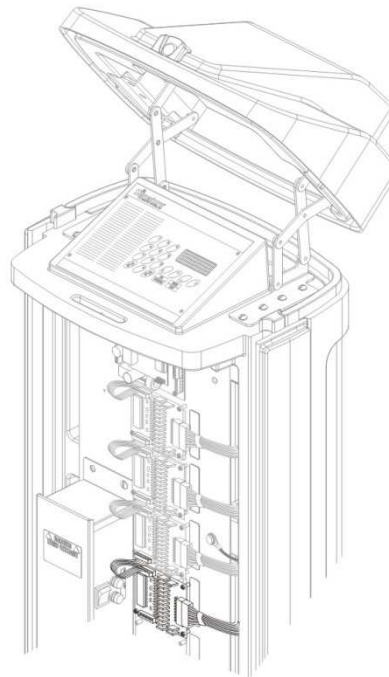

Front View